

Specifications

Nominal Voltage	12V	
Nominal Capacity (20HR)	40AH	
Dimension	Length	197mm (7.76 inches)
	Width	165mm (6.50 inches)
	Height	170mm (6.69 inches)
	Total Height (with Terminal)	170mm (6.69 inches)
	Approximate Weight	13.2 kg (29.1 lbs)
Battery Type	Valve Regulated Lead-Acid Battery, AGM Design	
Terminal Type	NB / IT	
Rated Capacity	40.6AH	(20hr, 1.75V/cell, 25°C/77°F)
	34.5AH	(10hr, 1.75V/cell, 25°C/77°F)
	34.2AH	(5hr, 1.75V/cell, 25°C/77°F)
	30.3AH	(3hr, 1.60V/cell, 25°C/77°F)
	24.6AH	(1hr, 1.60V/cell, 25°C/77°F)
Max. Discharge Current	540A	
Internal Resistance	9mΩ	
Operating Temp. Range	Discharge:	-20°C (-4°F)~50°C (122°F)
	Charge:	-20°C (-4°F)~50°C (122°F)
	Storage:	-20°C (-4°F)~40°C (104°F)
Nominal Operating Temp. Range	25±3°C (77±5°F)	
Container Material	ABS (Option: 94-HB & 94-V0 flame retardant case)	
Capacity affected by Temperature	40°C (104°F)	103%
	25°C (77°F)	100%
	0°C (32°F)	86%
Self Discharge	The CB Range of batteries may be stored for up to 6 months at 25°C (77°F) and then a freshening charge is recommended. For higher temperatures the time interval will be shorter.	



Applications

- Uninterruptible Power Supply (UPS)
- Electric wheelchairs, scooters, bikes
- Electronic apparatus and equipment
- Alarm and security systems
- Emergency first responder equipment
- Emergency lighting
- Medical devices
- Electric carts
- Telecom equipment
- Switchgear
- Solar power systems



Constant Current Discharge (Amperes Per Battery) at 25°C (77°F)

F.V. (V/cell) \ Discharge Time	5min	10min	15min	30min	1h	2h	3h	5h	8h	10h	20h
1.60V	171	108	81.0	40.9	24.6	13.9	10.1	7.13	5.35	3.82	2.14
1.65V	168	104	75.0	40.0	23.5	13.8	10.0	7.02	5.25	3.77	2.12
1.70V	157	102	72.0	38.9	23.2	13.5	9.62	6.98	5.10	3.73	2.07
1.75V	140	96.2	66.0	34.9	22.7	13.1	9.27	6.84	5.00	3.45	2.03
1.80V	131	86.3	61.2	30.7	22.5	12.6	9.17	6.68	4.90	3.27	1.95
1.85V	111	71.0	52.0	29.0	21.1	12.2	9.02	6.32	4.40	3.06	1.87

Constant Power Discharge (Watts Per Cell) at 25°C (77°F)

F.V. (V/cell) \ Discharge Time	5min	10min	15min	30min	1h	2h	3h	5h	8h	10h	20h
1.60V	325.2	200.0	154.5	82.3	45.5	28.0	21.1	14.5	8.33	6.70	3.53
1.65V	319.8	195.5	152.2	81.2	45.1	27.8	21.0	14.4	8.27	6.70	3.53
1.70V	299.2	192.5	143.5	76.5	44.5	27.3	20.0	14.2	8.17	6.68	3.51
1.75V	267.2	179.2	130.0	69.3	43.7	26.8	19.5	13.9	8.07	6.63	3.51
1.80V	222.8	159.7	110.5	59.0	42.4	25.8	18.8	13.6	7.93	6.55	3.45
1.85V	203.3	131.0	106.7	57.2	38.9	25.2	17.5	13.3	7.63	6.23	3.36

Dimensions

NB Terminal

Unit: mm (inches)

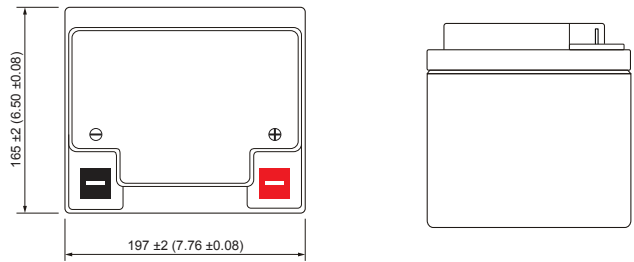
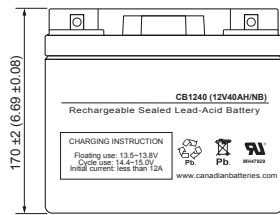
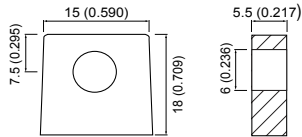

Cycle Service Life

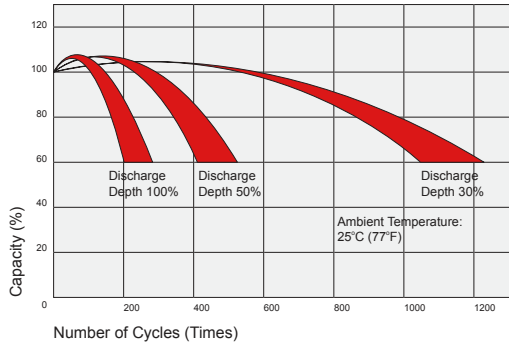

Self Discharge Characteristics

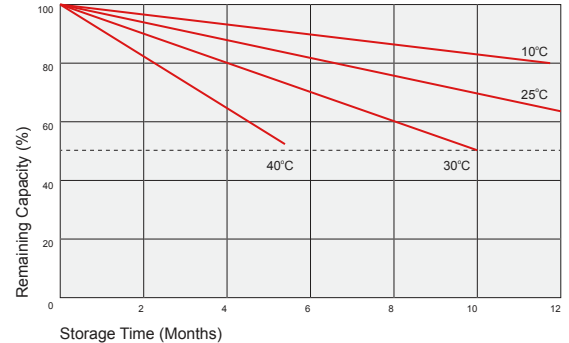

Discharge Characteristics

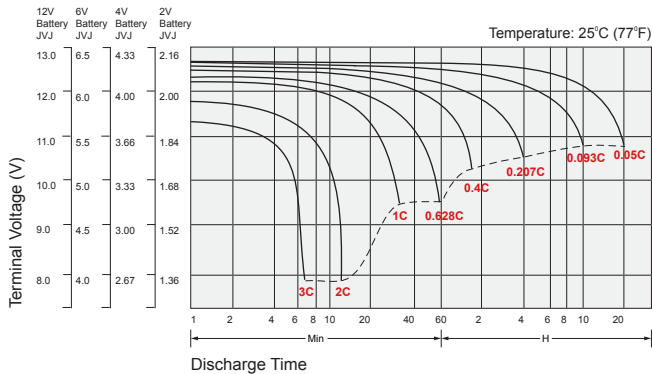

Float Charging Characteristics

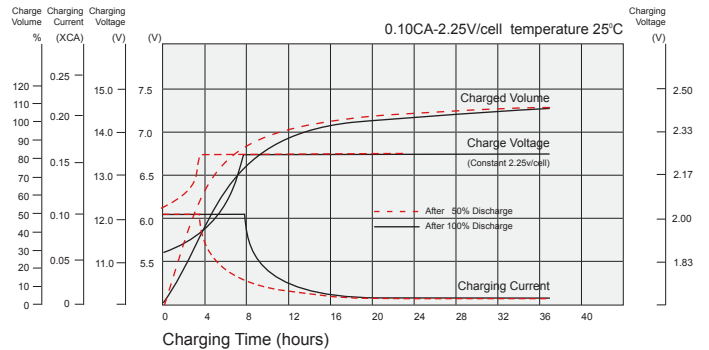

Temperature Effects in Relation to Battery Capacity

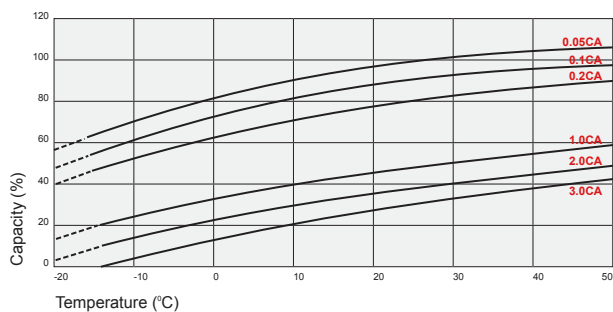

Temperature Effects on Long Term Float Life

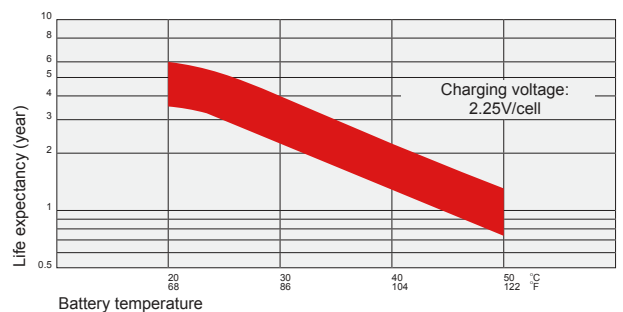

Contact Information

Canadian Batteries
PO Box 154,
Buckhorn, Ontario
K0L 1J0 Canada

T: +1-888-730-8658
F: +1-705-201-5466
www.canadianbatteries.com